

HARRAH'S NEW ORLEANS

Meeting Facilities – Hotel Second Floor

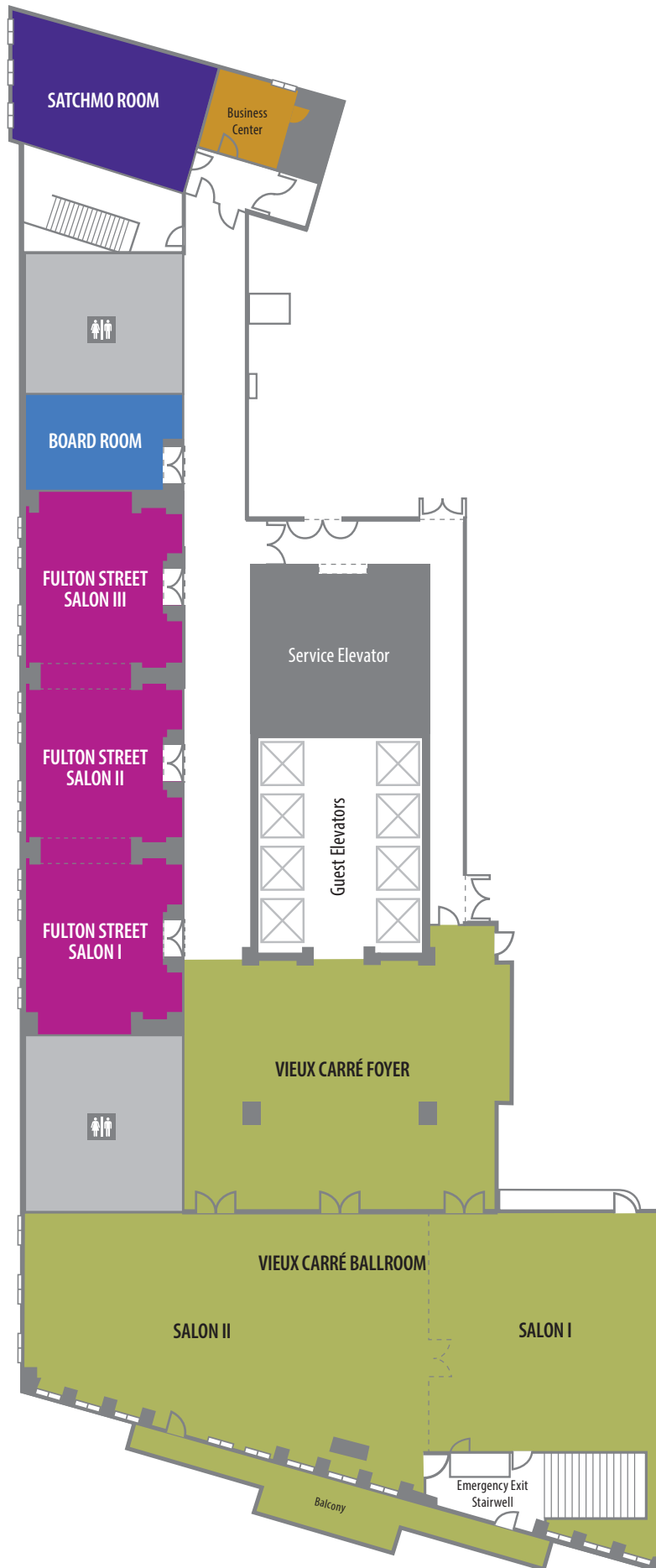

HARRAH'S NEW ORLEANS

Meeting Facilities – The Theater

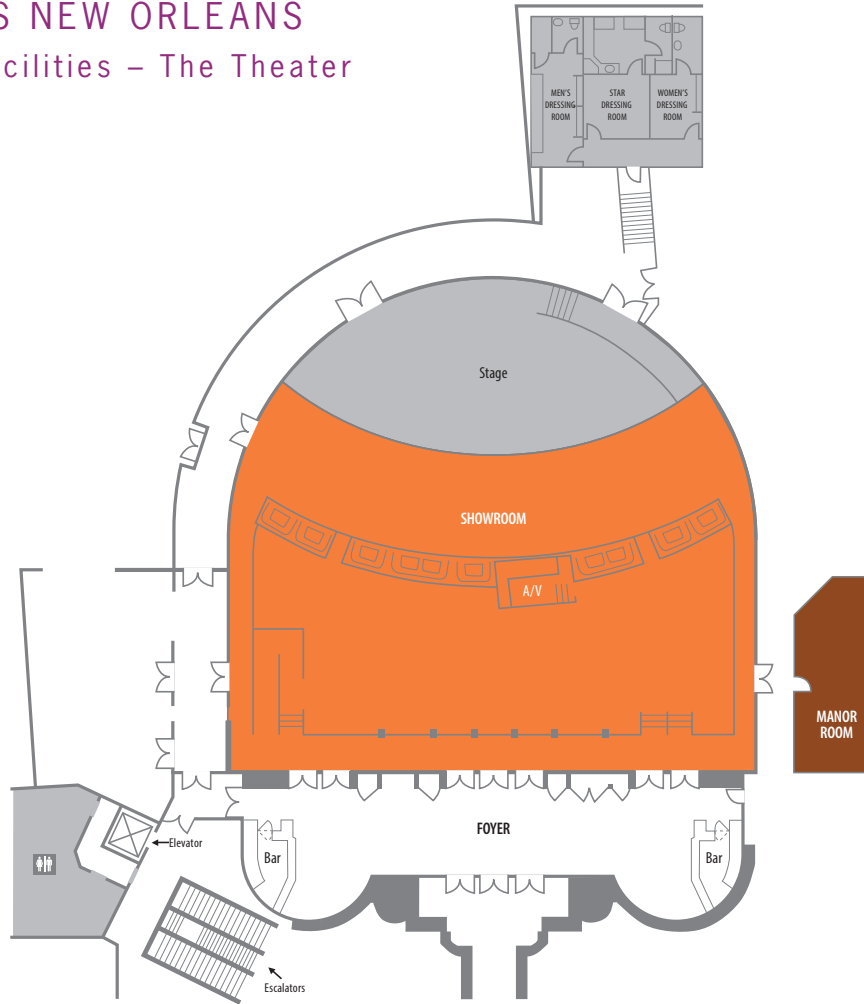

Meeting Facilities – Masquerade & Ultra Lounge

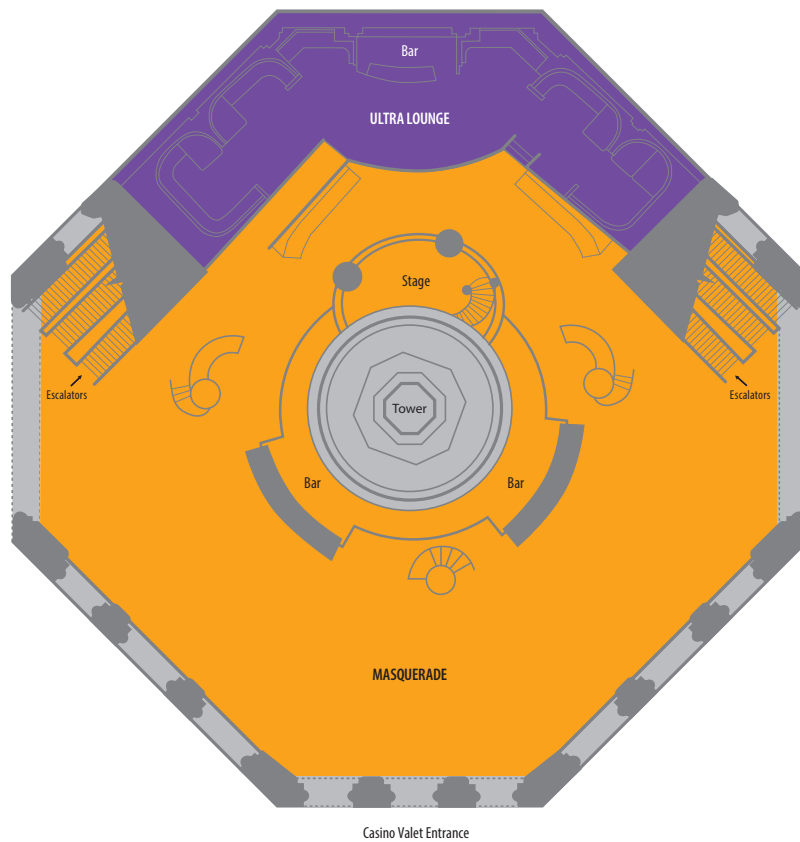

HARRAH'S NEW ORLEANS

Meeting Facilities – Manning's

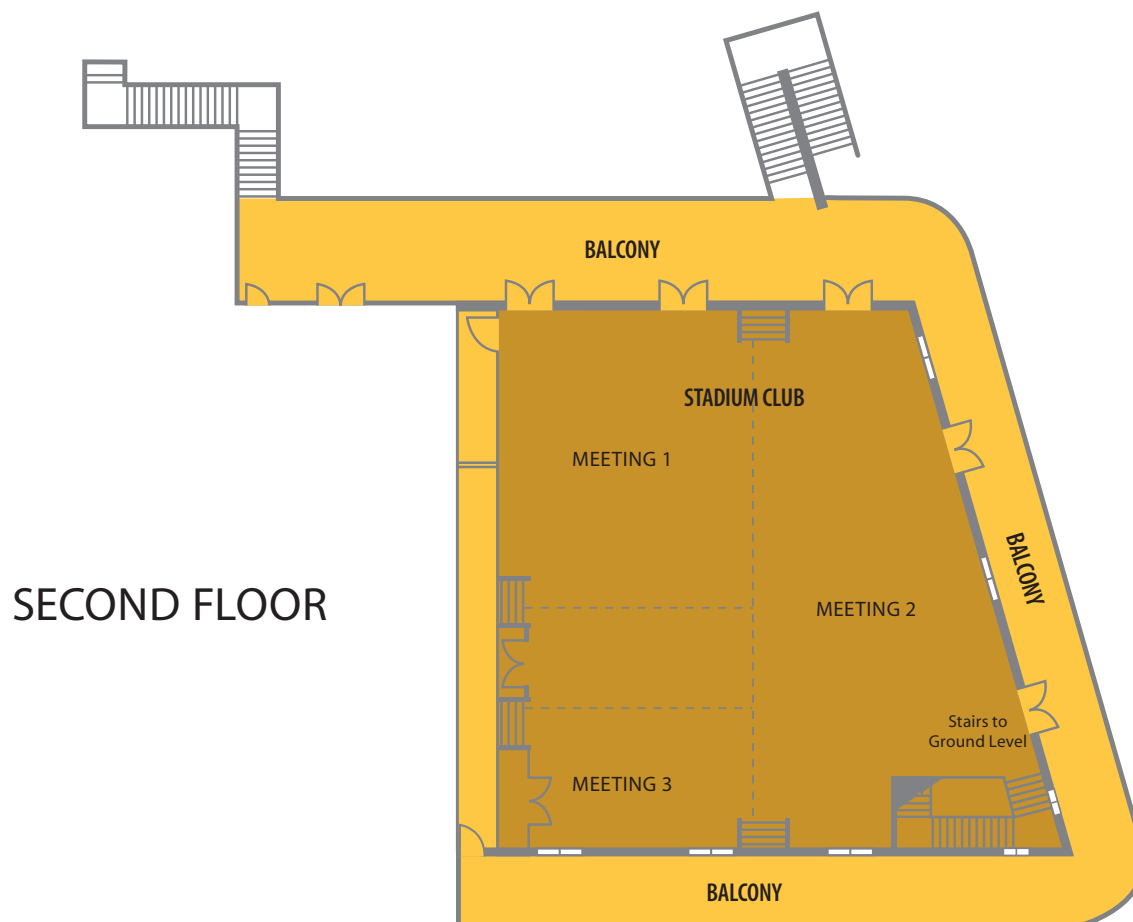
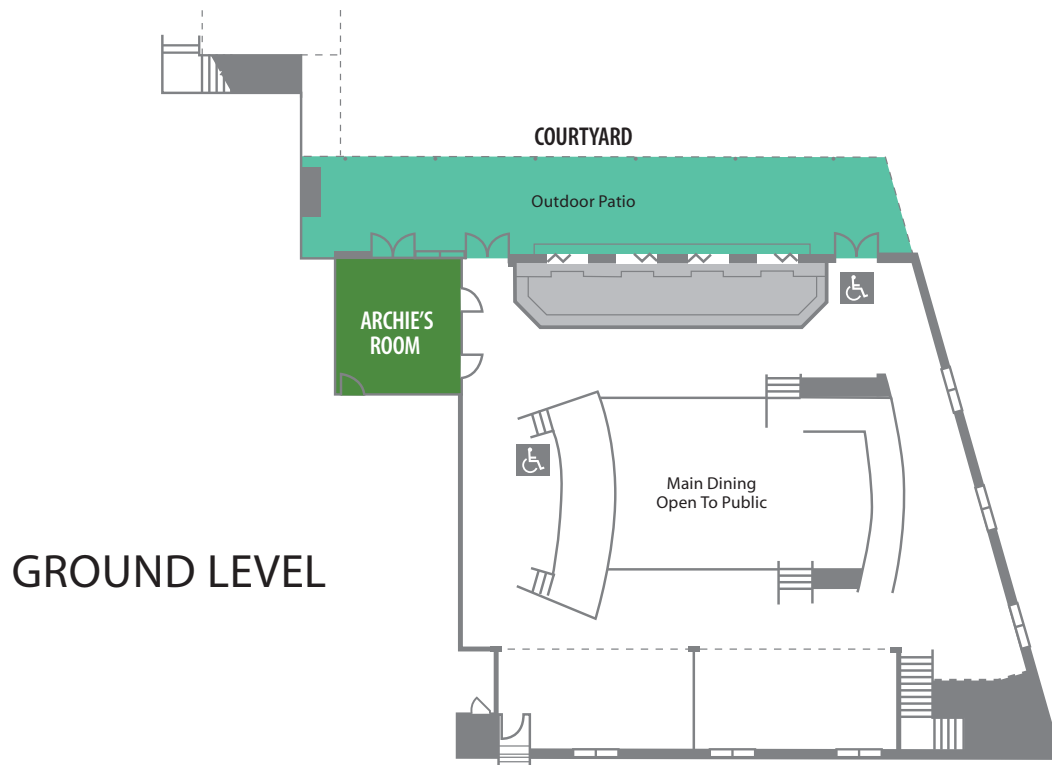

HOTEL MEETING ROOMS

Capacities and Dimensions

| MEETING ROOMS | SQ. FT. | WIDTH | LENGTH | CLASSROOM | THEATER | RECEPTION | BANQUET | U-SHAPE | H-SQUARE | CONF. |
|---|--------------|------------|------------|------------|------------|------------|------------|------------|------------|------------|
| Fulton Street Rooms | 2,175 | 87 | 25 | 75 | 135 | 137 | 120 | 72 | 75 | 75 |
| Salon I | 725 | 28 | 25 | 27 | 45 | 45 | 40 | 33 | 30 | 30 |
| Salon II | 725 | 28 | 25 | 27 | 45 | 45 | 40 | 33 | 30 | 30 |
| Salon III | 725 | 30 | 25 | 27 | 45 | 45 | 40 | 33 | 30 | 30 |
| Board Room | 355 | 23 | 18 | — | — | — | — | — | — | 8 |
| Vieux Carré Ballroom (with Outdoor Balcony) | 4,095 | 105 | 39 | 240 | 360 | 360 | 240 | 110 | 100 | 100 |
| Vieux Carré Foyer | 2,213 | — | — | — | — | 316 | — | — | — | — |
| Salon I | 1,480 | 38 | 39 | 60 | 120 | 150 | 80 | 45 | 30 | 30 |
| Salon II | 2,615 | 67 | 39 | 150 | 210 | 210 | 160 | 65 | 70 | 70 |
| Satchmo Room | 620 | 31 | 20 | 24 | 44 | 44 | 40 | 30 | 15 | 15 |
| The Theater | 9,000 | 56 | 101 | 250 | 520 | 800 | 400 | — | — | — |
| Manor Room (Adjacent to The Buffet) | 1,436 | 40 | 38 | — | — | 200 | 600 | — | — | — |
| Masquerade | 5,103 | 136 | 96 | — | — | 850 | — | — | — | — |
| Ultra Lounge | 3,113 | 24 | 88 | — | — | 150 | — | — | — | — |
| Fulton Street Promenade | 21,246 | 332 | 64 | — | 1,000 | 2,000 | 500 | — | — | — |

MANNING'S NEW ORLEANS

Capacities and Dimensions

| MEETING ROOMS | SQ.FT. | CLASSROOM | THEATER | RECEPTION | BANQUET | EXHIBITS |
|------------------------|--------------|------------|------------|------------|------------|-----------|
| Archie's Room | 300 | — | — | — | — | — |
| Courtyard | 1,500 | — | — | — | — | — |
| Stadium Club | 2,990 | 207 | 300 | 316 | 250 | 15 |
| Meeting Room 1 | 1,067 | 69 | 111 | 105 | 80 | — |
| Meeting Room 2 | 1,426 | 96 | 155 | 147 | 110 | — |
| Meeting Room 3 | 497 | 33 | 55 | 53 | 40 | — |
| Outdoor Balcony | 2,859 | — | — | 189 | — | — |